

# Allowable Load Combinations for Connection

P1 = 5200 lbs with U = 5170 lbs

## Maximum Connection Values

(U and P1 NOT in combination)

U<sub>max</sub> = 10370 lbs

P<sub>1max</sub> = 10370 lbs

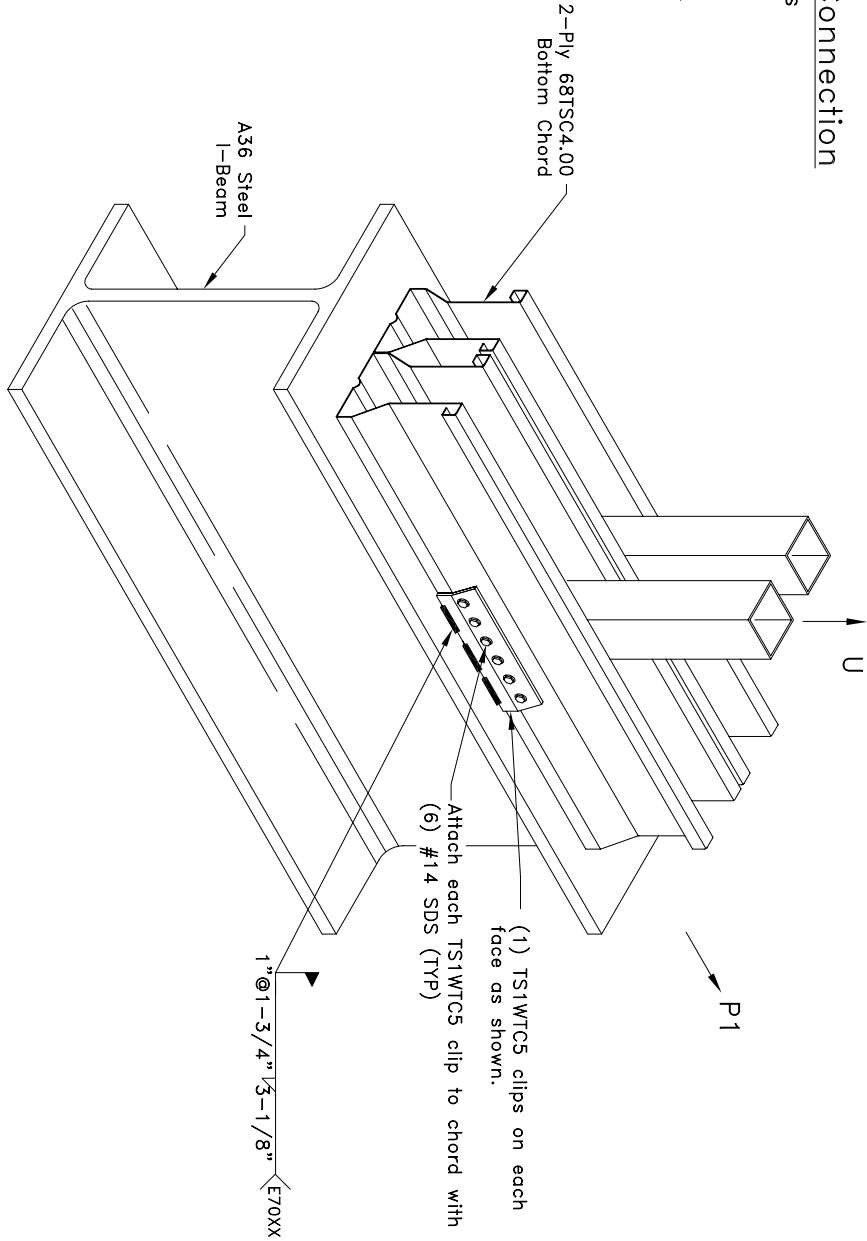

### General Notes:

1. SDS = Self-Drilling Tapping Screw
2. Attachment of clip on opposite face of chord is identical to what is detailed.
3. Clips must be positioned so that they are centered at web as shown.
4. Refer to TrusSteel Technical Bulletin 98.10.05 titled "Repair of Galvanized Surfaces" to restore corrosion resistant properties of the connection after welding.
5. The allowable loads outlined in this detail have not been increased by 1.33.
6. Weld values based on the use of an electrode type E70XX.
7. For other allowable load combinations, contact a TrusSteel Engineer.
8. Cold-Formed Steel Calculations are per the 2004 addendum to the AISI 2001 North American Specification for the design of Cold-Formed Steel Structural Members.

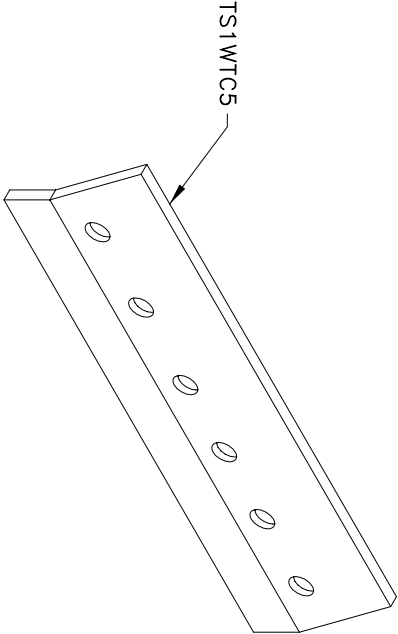

TS1WTC5 is 10g (Bare Metal Thickness = 0.128 in.)

**TrusSteel®**  
An ITW Company

[www.TrusSteel.com](http://www.TrusSteel.com)

Florida: 1950 Marley Drive / Haines City, FL 33844 / (800) 755-6001  
Missouri: 13389 Lakefront Drive / Earth City, MO 63045 / (800) 326-4102  
California: 8351 Rovana Circle / Sacramento, CA 95828 / (800) 877-3678

**(1) TS1WTC5 Clip Pair to  
A36 Steel - 2 Ply Truss**

ITW Building Components Group, Inc. shall not be responsible for any performance failure in a connection due to a deviation from this detail. Any variation from this detail shall be approved in advance by ITW Building Components Group, Inc.

### Custom Detail:

TS-CD-TB-S11-001

Date:

09/04/08

### Custom Detail:

Truss-to-Bearing Connection